

CAB BLINDS 3 PIECE SET **VW T5/T6 TRANSPORTER**

Fitting Instructions
(for windows 1,2 & 3)



Note: Whilst every effort has been made to ensure these instructions are as accurate and clear as possible, we cannot be held responsible for misinterpretation or any subsequent accident or damage caused through mis-fitted parts.

1

Thank you for your purchase; we want you to get the best results when using our products, so please be sure to read these instructions before attempting the installation of the blinds.

Tools required:

- Phillips screwdriver
- Electric drill
- 2mm drill bit

The set comprises:

- Windscreen Blind (x1)
- Front Door Blind (x2)
- Poppers (x4)
- Screws (x4)
- Storage bag (x1)

Windscreen Blind – Fixing the poppers

1. Before the windscreen blind can be fitted, you will need to fit two poppers to each of the front 'A' pillar trims. The poppers need to be positioned at each end of the groove that runs down the middle of the trim. (fig.1)

PLEASE NOTE: On some later vehicles there is no groove. If this is the case, then the poppers need to be fitted as follows:

Top Popper to be fitted 10mm down from the edge of the trim to the centre and 40mm from the windscreen (measured at 90° from the screen) to the centre of the popper.

Bottom Popper to be fitted 10mm up from the dash panel to the centre and 60mm from the windscreen (measured at 90° from the screen) to the centre of the popper.



Note: Whilst every effort has been made to ensure these instructions are as accurate and clear as possible, we cannot be held responsible for misinterpretation or any subsequent accident or damage caused through mis-fitted parts.

2. Drill a 2mm hole just before the end of the groove and screw the popper into place. Please do not over tighten the screw. (fig.2 & 3)



3. Repeat for the remaining poppers. (fig.4 & 5)

TIP: Place a piece of cardboard on the dash to prevent damage when drilling the bottom hole. It will also help to avoid losing the popper or screw down the gap in the dash.



Front Door Blinds – Fitting

1. Place the blind up to the door and attach the magnets to the metalwork reveal surrounding the window. You can adjust for best fit and tuck the curtain in at the bottom. (fig. 6,7,8,9,10,11 & 12)

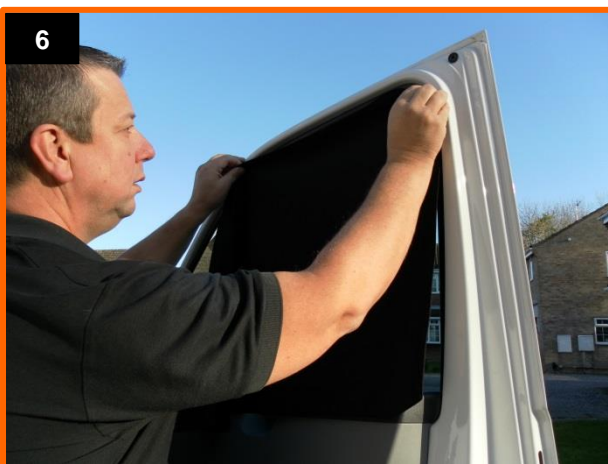

Note: Whilst every effort has been made to ensure these instructions are as accurate and clear as possible, we cannot be held responsible for misinterpretation or any subsequent accident or damage caused through mis-fitted parts.



Note: Whilst every effort has been made to ensure these instructions are as accurate and clear as possible, we cannot be held responsible for misinterpretation or any subsequent accident or damage caused through mis-fitted parts.

Windscreen Blind - Fitting

1. Place one of the elastic loops over one sun visor. (fig.13 & 14)

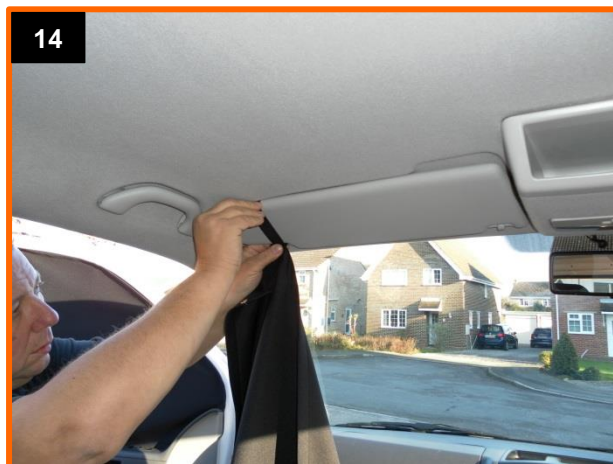
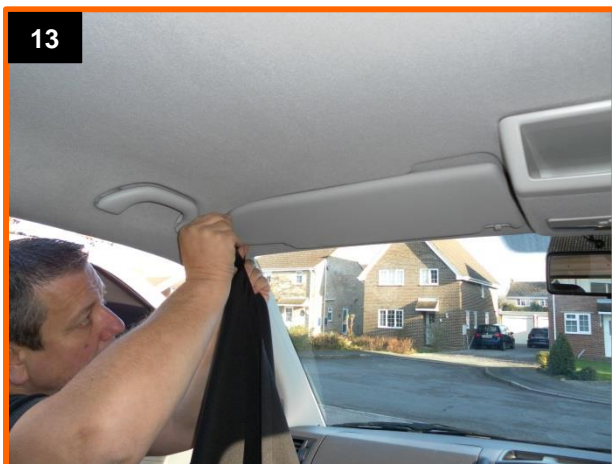

2. Pop on the two poppers. (15 & 16)

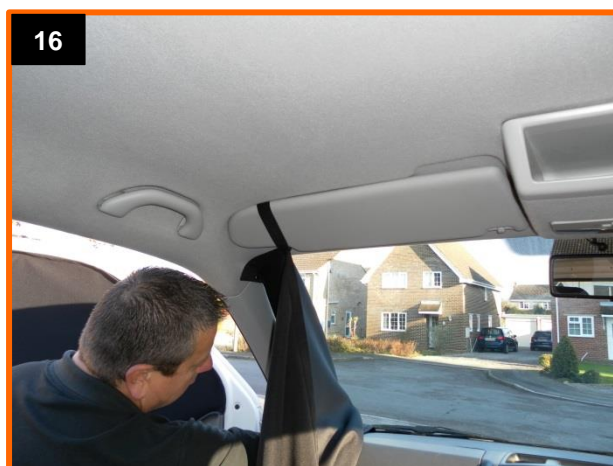
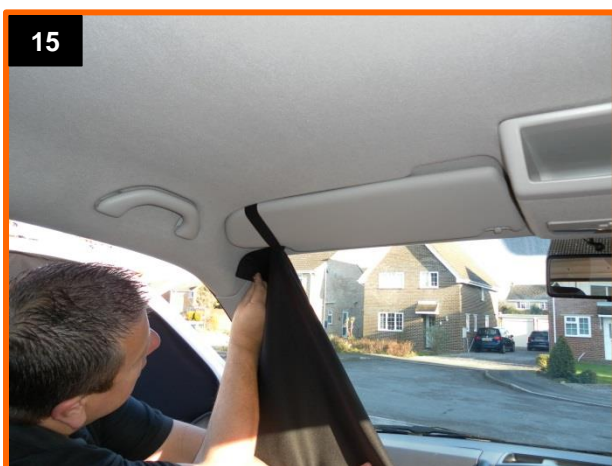

3. Repeat for the other side. (17 & 18)

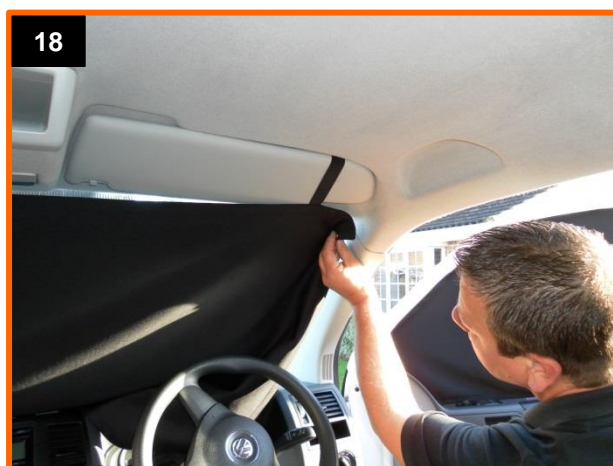
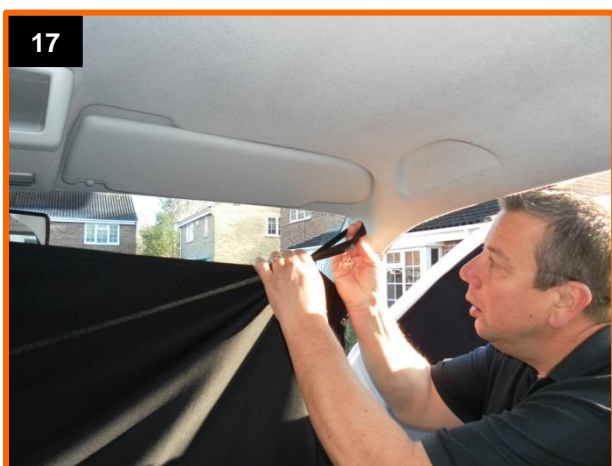

Note: Whilst every effort has been made to ensure these instructions are as accurate and clear as possible, we cannot be held responsible for misinterpretation or any subsequent accident or damage caused through mis-fitted parts.

4. Fold down one sun visor whilst holding the middle of the blind up in place. (fig.19 & 20)



5. Repeat for the other side. (fig.21 & 22)



6. Tuck the bottom of the blind forward towards the windscreen for a neat finish. (fig. 23,24 & 25)





The door blinds can be folded down halfway to let in daylight in the morning, but still retain some privacy.

All folds away in the supplied storage bag.

That's it you're done!

IF YOU ARE UNSURE OR NEED ANY ADVICE, PLEASE CONTACT US

Note: Whilst every effort has been made to ensure these instructions are as accurate and clear as possible, we cannot be held responsible for misinterpretation or any subsequent accident or damage caused through mis-fitted parts.