

# QWW-CF150-01

# Plastic Pipe penetrating a rigid floor (150mm or thicker)

This standard detail is intended for general information only and all details should be checked against all relevant supporting test evidence, certification and installation guidelines. In line with the company's policy of continual development, details are subject to change and/ or withdrawal therefore you must ensure this is the latest published detail and instructions.

Additional Instructions
The floor must have a minimum thickness of 150mm and comprise of concrete, aerated concrete or masonry, with a minimum density of 650kg/m <sup>3</sup> .
Install the correct size QWW Intuwrap around the plastic pipe to the lower side of the seal.
Quelfire recommend QF2 Fire Protection Compound is then used as the mortar backfill.
BS EN 1366-3:2021 Section 13.7: The distance between the aperture edges of penetration seals in a building element shall be as tested or minimum 100mm. The distance between the aperture edge of a penetration seal and any other penetration (e.g., door) in a building element shall be minimum 200mm.

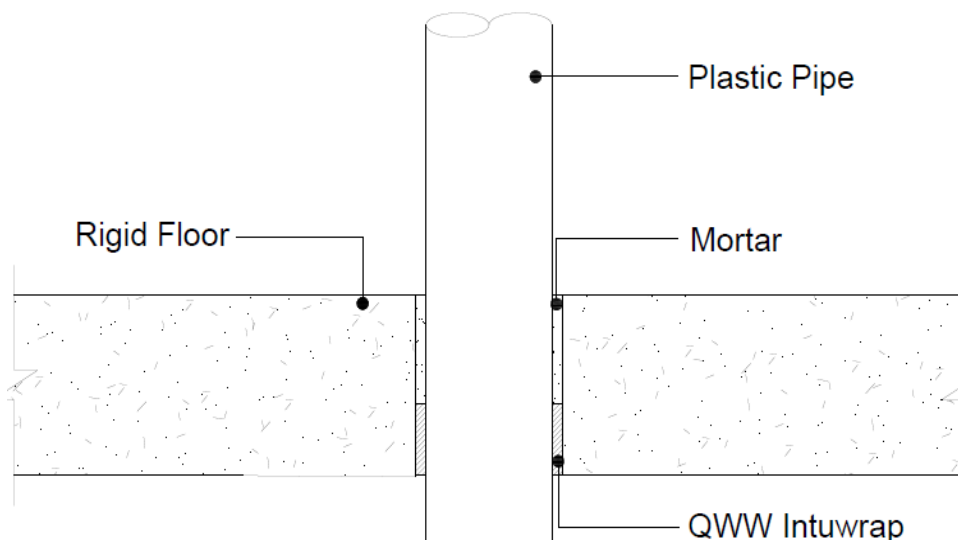

Quelfire Products Required	
Product Code	Description
QF2	QF2 Fire Protection Compound
QWW32/CE	Intuwrap to suit 32mm pipes
QWW40/CE	Intuwrap to suit 40mm pipes
QWW50/CE	Intuwrap to suit 50mm pipes
QWW55/CE	Intuwrap to suit 55mm pipes
QWW63/CE	Intuwrap to suit 63mm pipes
QWW75/CE	Intuwrap to suit 75mm pipes
QWW82/CE	Intuwrap to suit 82mm pipes
QWW90/CE	Intuwrap to suit 90mm pipes
QWW110/CE	Intuwrap to suit 110mm pipes
QWW125/CE	Intuwrap to suit 125mm pipes
QWW160/CE	Intuwrap to suit 160mm pipes

Plastic Pipe Type	Page No.
U-PVC	1
HDPE	2
PP	3

Service Type	Size of Service	Pipe Wall Thickness	Recommend Hole Dia.	QWW Wrap	Classification	
U-PVC	Ø32mm	See Graph on ETA	Ø40mm	QWW32/CE	EI 240 U/C	
	Ø40mm		Ø50mm	QWW40/CE		
	Ø50mm		Ø60mm	QWW50/CE		
	Ø55mm	2.4 - 3.7mm	Ø74mm	QWW55/CE		
	Ø63mm		Ø82mm	QWW63/CE		
	Ø75mm		Ø94mm	QWW75/CE		
	Ø82mm	See Graph on ETA	Ø102mm	QWW82/CE		
	Ø90mm		Ø110mm	QWW90/CE		
	Ø110mm		Ø132mm	QWW110/CE		
	Ø125mm	4.2 - 6.6mm	Ø155mm	QWW125/CE		E 240 U/C EI 60 U/C
	Ø160mm	6.2mm 6.2 - 9.5mm	Ø204mm	QWW160/CE		E 240 U/C EI 60 U/C
						EI 60 U/C

Spacing as per BS EN 1366-3: 2021, Section 13.7	
* Please also consider any requirements that the floor manufacturer has with regards to spacing between openings.	
Minimum distance from edge of opening to another aperture with a service penetration tested to BS EN 1366-3	100mm*
Minimum distance from edge of opening to another aperture with a penetration <u>not</u> tested to BS EN 1366-3	200mm*

<b>To be read in conjunction with:</b>	QWW CE Marked Intuwrap ETA 20-1205 pages 11 - 12
<b>Test standard:</b>	BS EN1366-3 & EN13501-2:2016
<b>Substrate minimum thickness:</b>	150mm
<b>First service support:</b>	≤250mm
<b>Drawing Scale:</b>	Not to Scale
<b>Issue Number:</b>	4
<b>Date of Issue:</b>	January 2023
<b>Detail Reference:</b>	QWW-CF150-01

### Important Information:

- The supporting construction must be installed in accordance with the manufacturer's guidelines and must be capable of achieving the required fire rating of the firestop.
- All Services should be adequately supported either side of the firestop to ensure that no load is transferred onto the firestop seal.

### Scope and Liability:

- Any information provided by or on behalf of Quelfire Limited is provided for general information only. It is not intended to amount to advice on which you should rely. You must obtain professional or specialist advice before taking, or refraining from, any recommendation or action.
- The summary is not exhaustive and does not consider all issues relevant to the enquiry. It is limited to the information and time available to us. We have not verified any information made available to us by you or any other source, nor have we carried out a physical inspection of any property. We make no representations, warranties or guarantees, whether expressed or implied, that any information is accurate, complete or up to date.
- We do not accept a duty of care to you or any other person in respect of the enquiry, nor do we accept any liability to you or any other person for any loss arising out of or in connection with the enquiry or any reply provided by us. Different limitations and exclusions of liability arising as a result of the supply of any products or services by us to you, and these will be set out in our terms and conditions of supply, a copy of which is available on request.
- Full terms and conditions of sale are available at <https://www.quelfire.co.uk/terms-conditions-of-sale/>

# QWW-CF150-01

# Plastic Pipe penetrating a rigid floor (150mm or thicker)

This standard detail is intended for general information only and all details should be checked against all relevant supporting test evidence, certification and installation guidelines  
In line with the company's policy of continual development, details are subject to change and/ or withdrawal therefore you must ensure this is the latest published detail and instructions.

**Additional Instructions**

The floor must have a minimum thickness of 150mm and comprise of concrete, aerated concrete or masonry, with a minimum density of 650kg/m<sup>3</sup>.

Install the correct size QWW Intuwrap around the plastic pipe to the lower side of the seal.

Quelfire recommend QF2 Fire Protection Compound is then used as the mortar backfill.

BS EN 1366-3:2021 Section 13.7: The distance between the aperture edges of penetration seals in a building element shall be as tested or minimum 100mm.

The distance between the aperture edge of a penetration seal and any other penetration (e.g., door) in a building element shall be minimum 200mm.

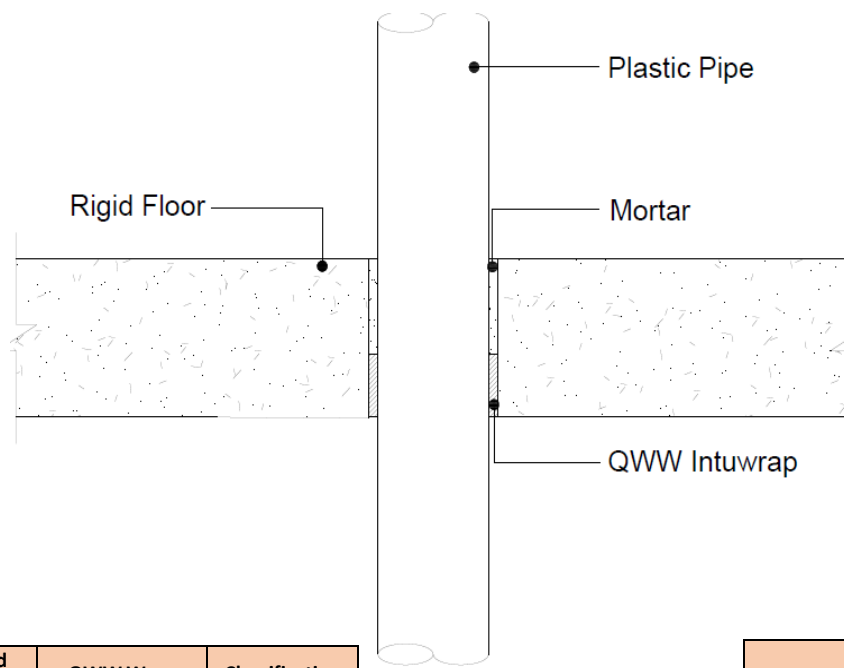

Quelfire Products Required	
Product Code	Description
QF2	QF2 Fire Protection Compound
QWW32/CE	Intuwrap to suit 32mm pipes
QWW40/CE	Intuwrap to suit 40mm pipes
QWW50/CE	Intuwrap to suit 50mm pipes
QWW55/CE	Intuwrap to suit 55mm pipes
QWW63/CE	Intuwrap to suit 63mm pipes
QWW75/CE	Intuwrap to suit 75mm pipes
QWW82/CE	Intuwrap to suit 82mm pipes
QWW90/CE	Intuwrap to suit 90mm pipes
QWW110/CE	Intuwrap to suit 110mm pipes
QWW125/CE	Intuwrap to suit 125mm pipes
QWW160/CE	Intuwrap to suit 160mm pipes

Plastic Pipe Type	Page No.
U-PVC	1
<b>HDPE</b>	<b>2</b>
PP	3

Service Type	Size of Service	Pipe Wall Thickness	Recommend Hole Dia.	QWW Wrap	Classification	
PE, PE-X, ABS, SAN-PVC** Pipe	Ø32mm	See Graph on ETA	Ø40mm	QWW32/CE	EI 240 U/C	
	Ø40mm		Ø50mm	QWW40/CE		
	Ø50mm	3.0 – 4.6mm	Ø60mm	QWW50/CE		
	Ø55mm		Ø74mm	QWW55/CE		
	Ø63mm	See Graph on ETA	Ø82mm	QWW63/CE		
	Ø75mm		Ø94mm	QWW75/CE		
	Ø82mm		Ø102mm	QWW82/CE		
	Ø90mm		Ø110mm	QWW90/CE		
	Ø110mm	3.4 - 6.6mm	Ø132mm	QWW110/CE		EI 45 U/C
	Ø125mm		Ø155mm	QWW125/CE		
Ø160mm	9.5mm	Ø204mm	QWW160/CE			

\*PE in accordance with EN1519-1, EN1266-1, EN 12201-2 and EN ISO 15494, PE-X in accordance with EN ISO 15875-2, ABS in accordance with EN 1455-1 and EN ISO 15493 as well as SAN+PVC in accordance with ISO 19220

**Spacing as per BS EN 1366-3: 2021, Section 13.7**  
\* Please also consider any requirements that the floor manufacturer has with regards to spacing between openings.

Minimum distance from edge of opening to another aperture with a service penetration tested to BS EN 1366-3	100mm*
Minimum distance from edge of opening to another aperture with a penetration <u>not</u> tested to BS EN 1366-3	200mm*

<b>To be read in conjunction with:</b>	QWW CE Marked Intuwrap ETA 20-1205 pages 12 - 13
<b>Test standard:</b>	BS EN1366-3:2009 & EN13501-2:2016
<b>Substrate minimum thickness:</b>	150mm
<b>First service support:</b>	≤250mm
<b>Drawing Scale:</b>	Not to Scale
<b>Issue Number:</b>	4
<b>Date of Issue:</b>	January 2023
<b>Detail Reference:</b>	QWW-CF150-01

**Important Information:**

- The supporting construction must be installed in accordance with the manufacturer's guidelines and must be capable of achieving the required fire rating of the firestop.
- All Services should be adequately supported either side of the firestop to ensure that no load is transferred onto the firestop seal.

**Scope and Liability:**

- Any Information provided by or on behalf of Quelfire Limited is provided for general information only. It is not intended to amount to advice on which you should rely. You must obtain professional or specialist advice before taking, or refraining from, any recommendation or action.
- The summary is not exhaustive and does not consider all issues relevant to the enquiry. It is limited to the information and time available to us. We have not verified any information made available to us by you or any other source, nor have we carried out a physical inspection of any property. We make no representations, warranties or guarantees, whether expressed or implied, that any information is accurate, complete or up to date.
- We do not accept a duty of care to you or any other person in respect of the enquiry, nor do we accept any liability to you or any other person for any loss arising out of or in connection with the enquiry or any reply provided by us. Different limitations and exclusions of liability arising as a result of the supply of any products or services by us to you, and these will be set out in our terms and conditions of supply, a copy of which is available on request.
- Full terms and conditions of sale are available at <https://www.quelfire.co.uk/terms-conditions-of-sale/>

# QWW-CF150-01

# Plastic Pipe penetrating a rigid floor (150mm or thicker)

This standard detail is intended for general information only and all details should be checked against all relevant supporting test evidence, certification and installation guidelines. In line with the company's policy of continual development, details are subject to change and/ or withdrawal therefore you must ensure this is the latest published detail and instructions.

Additional Instructions
The floor must have a minimum thickness of 150mm and comprise of concrete, aerated concrete or masonry, with a minimum density of 650kg/m <sup>3</sup> .
Install the correct size QWW Intuwrap around the plastic pipe to the lower side of the seal.
Quelfire recommend QF2 Fire Protection Compound is then used as the mortar backfill.
BS EN 1366-3:2021 Section 13.7: The distance between the aperture edges of penetration seals in a building element shall be as tested or minimum 100mm. The distance between the aperture edge of a penetration seal and any other penetration (e.g., door) in a building element shall be minimum 200mm.

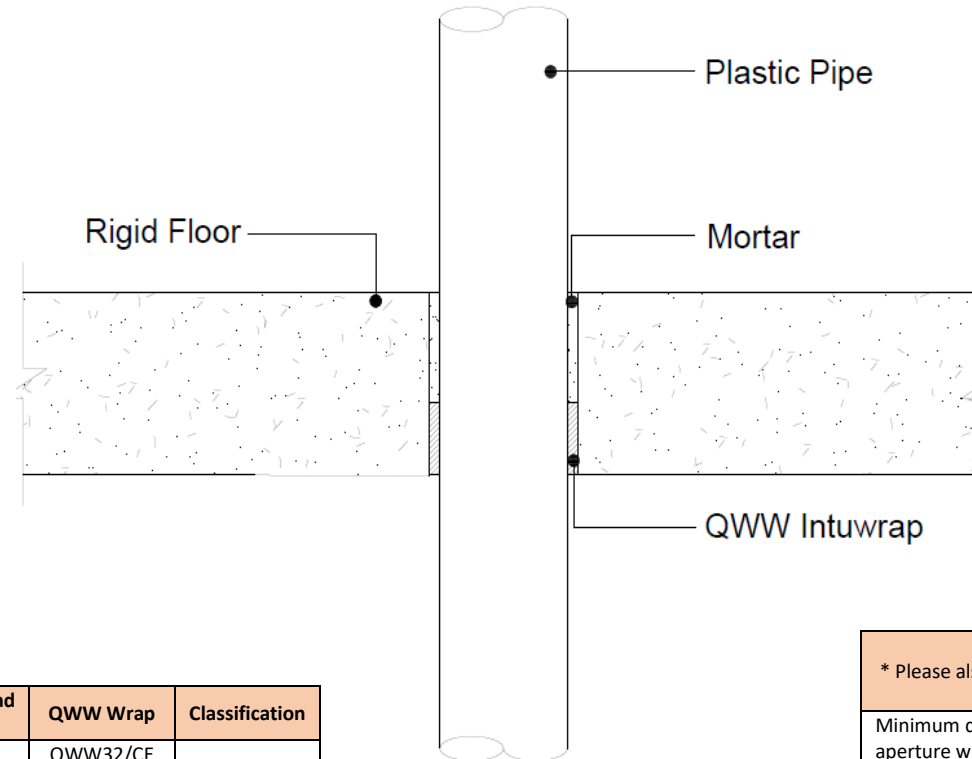

Quelfire Products Required	
Product Code	Description
QF2	QF2 Fire Protection Compound
QWW32/CE	Intuwrap to suit 32mm pipes
QWW40/CE	Intuwrap to suit 40mm pipes
QWW50/CE	Intuwrap to suit 50mm pipes
QWW55/CE	Intuwrap to suit 55mm pipes
QWW63/CE	Intuwrap to suit 63mm pipes
QWW75/CE	Intuwrap to suit 75mm pipes
QWW82/CE	Intuwrap to suit 82mm pipes
QWW90/CE	Intuwrap to suit 90mm pipes
QWW110/CE	Intuwrap to suit 110mm pipes
QWW125/CE	Intuwrap to suit 125mm pipes
QWW160/CE	Intuwrap to suit 160mm pipes

Plastic Pipe Type	Page No.
U-PVC	1
HDPE	2
PP	3

Service Type	Size of Service	Pipe Wall Thickness	Recommend Hole Dia.	QWW Wrap	Classification
PP	Ø32mm	See Graph on ETA	Ø40mm	QWW32/CE	EI 240 U/C
	Ø40mm		Ø50mm	QWW40/CE	
	Ø50mm		Ø60mm	QWW50/CE	
	Ø55mm	See Graph on ETA	Ø74mm	QWW55/CE	
	Ø63mm		Ø82mm	QWW63/CE	
	Ø75mm		Ø94mm	QWW75/CE	
	Ø82mm		Ø102mm	QWW82/CE	
	Ø90mm	2.7 – 10.0mm	Ø110mm	QWW90/CE	
	Ø110mm		Ø132mm	QWW110/CE	
	Ø125mm		Ø155mm	QWW125/CE	
Ø160mm	9.1mm	Ø204mm	QWW160/CE	EI 45 U/C	

Spacing as per BS EN 1366-3: 2021, Section 13.7	
* Please also consider any requirements that the floor manufacturer has with regards to spacing between openings.	
Minimum distance from edge of opening to another aperture with a service penetration tested to BS EN 1366-3	100mm*
Minimum distance from edge of opening to another aperture with a penetration <b>not</b> tested to BS EN 1366-3	200mm*

<b>To be read in conjunction with:</b>	QWW CE Marked Intuwrap ETA 20-1205 pages 13 - 14
<b>Test standard:</b>	BS EN1366-3:2009 & EN13501-2:2016
<b>Substrate minimum thickness:</b>	150mm
<b>First service support:</b>	≤250mm
<b>Drawing Scale:</b>	Not to Scale
<b>Issue Number:</b>	4
<b>Date of Issue:</b>	January 2023
<b>Detail Reference:</b>	QWW-CF150-01

### Important Information:

- The supporting construction must be installed in accordance with the manufacturer's guidelines and must be capable of achieving the required fire rating of the firestop.
- All Services should be adequately supported either side of the firestop to ensure that no load is transferred onto the firestop seal.

### Scope and Liability:

- Any information provided by or on behalf of Quelfire Limited is provided for general information only. It is not intended to amount to advice on which you should rely. You must obtain professional or specialist advice before taking, or refraining from, any recommendation or action.
- The summary is not exhaustive and does not consider all issues relevant to the enquiry. It is limited to the information and time available to us. We have not verified any information made available to us by you or any other source, nor have we carried out a physical inspection of any property. We make no representations, warranties or guarantees, whether expressed or implied, that any information is accurate, complete or up to date.
- We do not accept a duty of care to you or any other person in respect of the enquiry, nor do we accept any liability to you or any other person for any loss arising out of or in connection with the enquiry or any reply provided by us. Different limitations and exclusions of liability arising as a result of the supply of any products or services by us to you, and these will be set out in our terms and conditions of supply, a copy of which is available on request.
- Full terms and conditions of sale are available at <https://www.quelfire.co.uk/terms-conditions-of-sale/>